

# NORTHSIDE NEIGHBORHOOD IMPROVEMENT PLAN DILLARD STREET AND ALLEY IMPROVEMENTS

CITY OF  
MARTINSVILLE, VIRGINIA

AUGUST 2016

CDBG CIG No. 13-14

**SHEET LIST:**

1. TITLE SHEET
2. TYPICAL SECTIONS AND NOTES
3. PLAN - DILLARD STREET PAVING
4. PLAN - EXISTING ALLEY EXTENSION OFF OF DILLARD ST. AND ENTRANCE OFF OF WARREN COURT
5. PROFILES - ALLEY AND ENTRANCES
6. ROADSIDE DEVELOPMENT

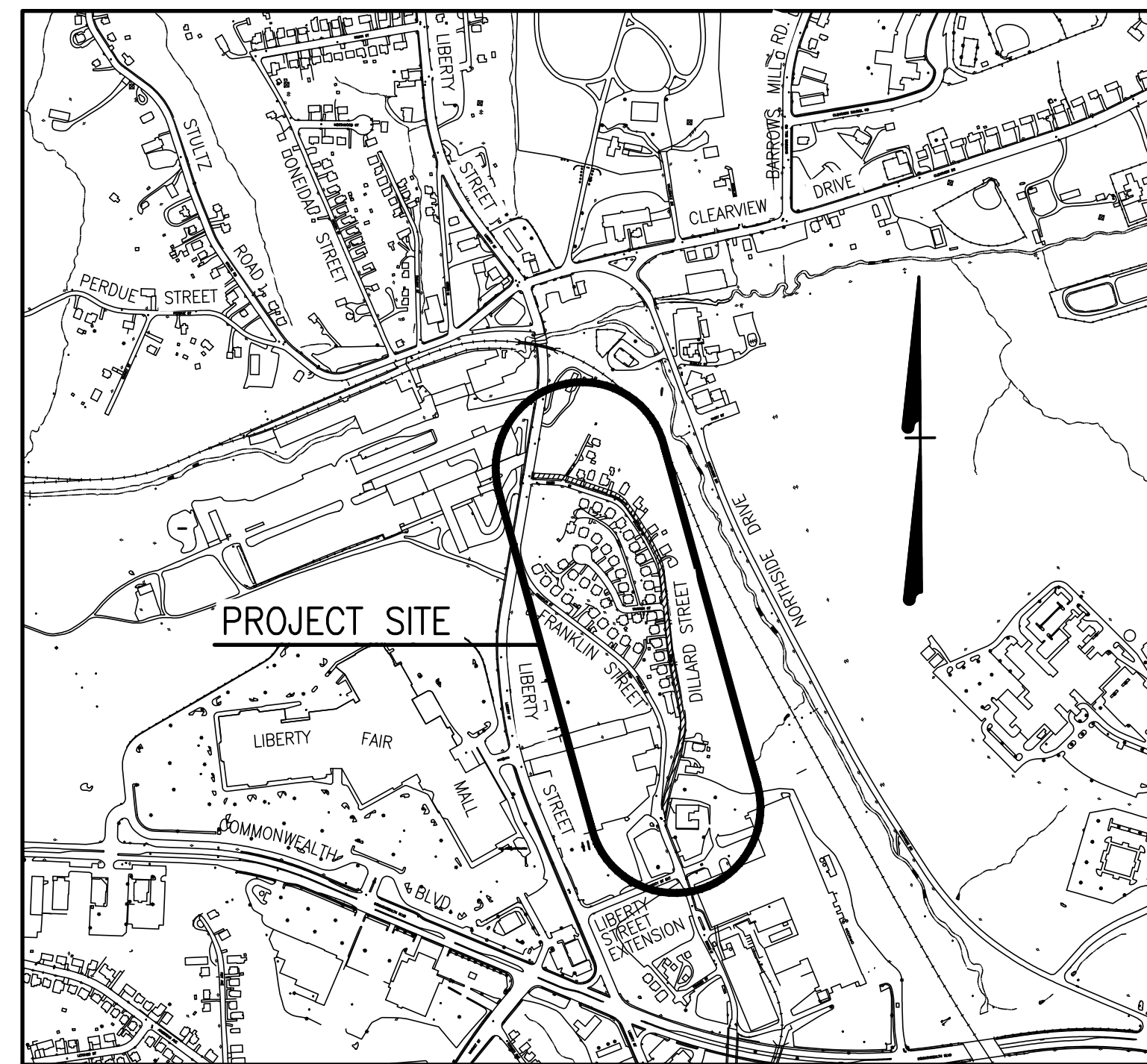

**LOCATION MAP**  
SCALE: NONE

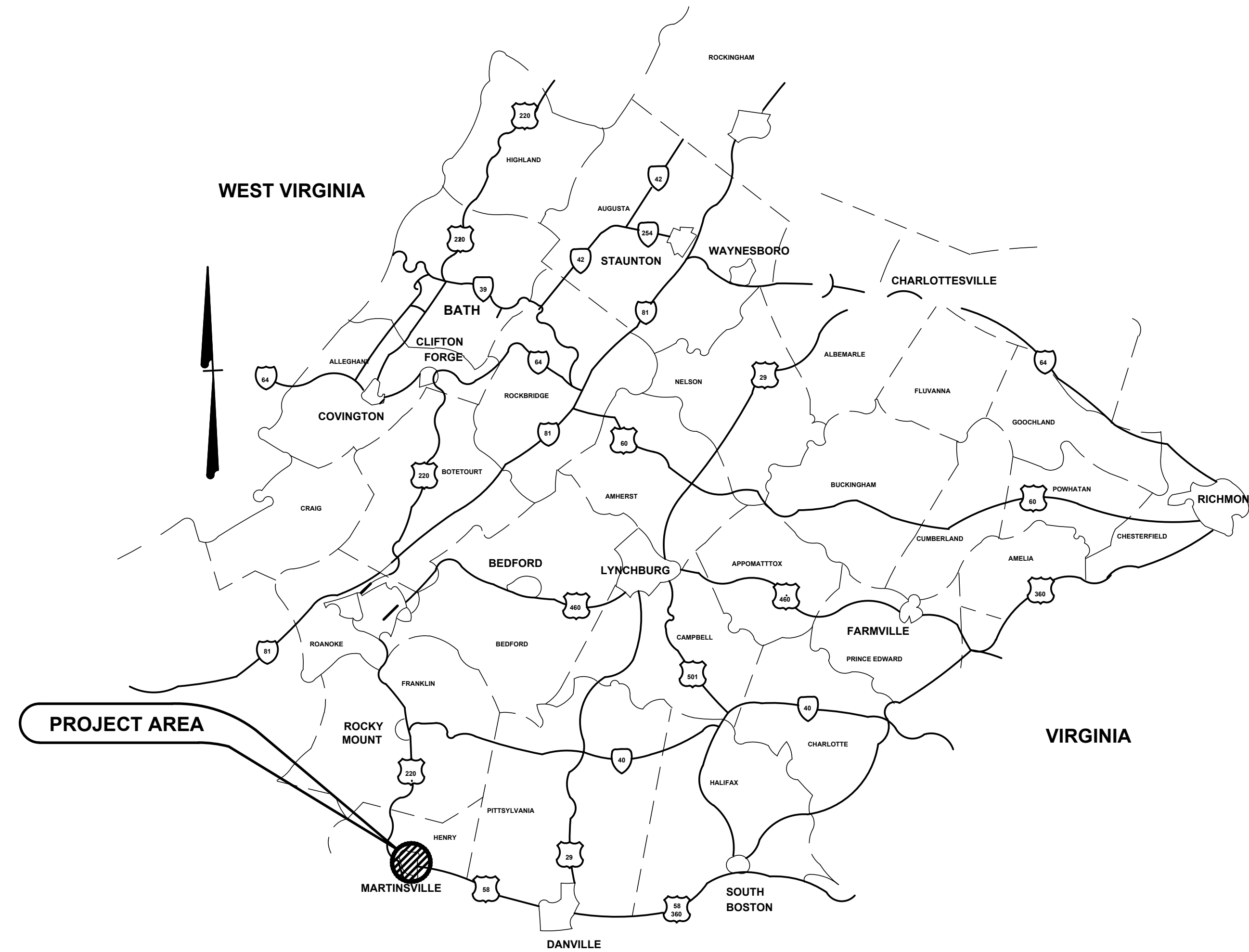

**VICINITY MAP**  
**MARTINSVILLE, VIRGINIA**  
SCALE: NONE

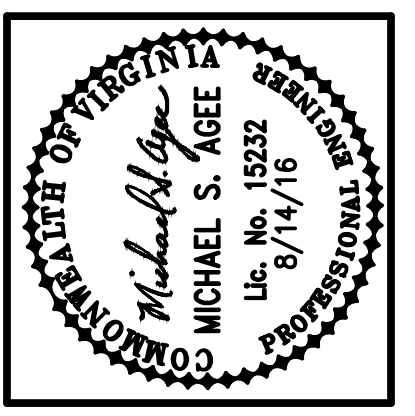

Date:	
Revisions:	

Issue Date: August 14, 2016  
 Drawn By: RSM  
 Designed By: RSM  
 Checked By: MSA  
 Date: 8/10/16

**Mattern & Craig**  
 ENGINEERS SURVEYORS  
 701 FIRST STREET, S.W.  
 ROANOKE, VIRGINIA 24016  
 (540) 345-9342  
 FAX (540) 345-7891

NORTHSIDE NEIGHBORHOOD IMPROVEMENT PLAN  
 DILLARD STREET AND ALLEY IMPROVEMENTS  
**TITLE SHEET**  
 MARTINSVILLE, VIRGINIA

Vertical Scale:  
NO SCALE

Horizontal Scale:  
NO SCALE

Commission Number:  
3514

Sheet No.:  
**1**

SET NO. \_\_\_\_\_

**GENERAL NOTES:**

- THIS PROJECT IS TO BE CONSTRUCTED IN ACCORDANCE WITH THE PROJECT SPECIFICATIONS, THESE PLANS, VDOT ROAD AND BRIDGE SPECIFICATIONS DATED 2007, VDOT ROAD AND BRIDGE STANDARDS DATED 2008, AND THE VIRGINIA WORK AREA PROJECTION MANUAL, REV. 1, DATED AUGUST 2011 AND AS AMENDED BY CONTRACT PROVISIONS AND THESE PLANS. THE CONTRACTOR SHALL NOTIFY THE CITY OF MARTINSVILLE CITY ENGINEER 24 HOURS BEFORE COMMENCING CONSTRUCTION.
- CONTRACTOR SHALL MAINTAIN TWO-WAY TRAFFIC AT ALL TIMES, UNLESS OTHERWISE ALLOWED BY THE CITY.
- THE PLAN SET IS INCOMPLETE UNLESS ACCOMPANIED BY THE PROJECT MANUAL. LIKewise, THE PROJECT MANUAL IS INCOMPLETE UNLESS ACCOMPANIED BY THE PLANS.
- THE CONTRACTOR SHALL CONTACT "MISS UTILITY" (1-800-552-7001) AT LEAST 48 HOURS BEFORE BEGINNING LAND DISTURBING ACTIVITIES TO OBTAIN FIELD UTILITY LOCATIONS. CERTAIN UTILITIES WITHIN THE VICINITY OF THE PROJECT AREA ARE SHOWN ON THE PLANS. THE UTILITIES SHOWN ARE NOT GUARANTEED TO BE COMPLETE OR ACCURATELY LOCATED. THE CONTRACTOR IS RESPONSIBLE FOR LOCATION OF ALL EXISTING UTILITIES, INCLUDING WATER LATERALS, SANITARY SEWER LATERALS, GAS LATERALS, ETC. AND LIGHTING SYSTEMS BEFORE PROCEEDING WITH WORK.
- CONTRACTOR SHALL TOPSOIL, MULCH AND SEED ALL DISTURBED AREAS NOT PAVED IN ACCORDANCE WITH THE SPECIFICATIONS.
- ACCESS TO PRIVATE ENTRANCES SHALL BE MAINTAINED AT ALL TIMES.
- ALL GRADING AND PAVING SHALL BE PERFORMED IN SUCH A MANNER AS TO ELIMINATE FALSE GUTTERS AND/OR PONDED WATER.
- THE PAVEMENT MATERIALS ON THIS PROJECT WILL BE PAID FOR ON A TONNAGE BASIS. THE WEIGHT WILL VARY IN ACCORDANCE WITH THE SPECIFIC GRAVITY OF THE AGGREGATES AND THE ASPHALTIC CONTENT OF THE MIX ACTUALLY USED TO SECURE THE DESIGN DEPTH. THE WEIGHT OF THE ASPHALT CONCRETE IS BASED ON 95% OF THE THEORETICAL MAXIMUM DENSITY.
- CLEARING AND GRUBBING SHALL BE CONFINED TO THOSE AREAS NEEDED FOR CONSTRUCTION. NO TREES OR SHRUBS IN UNGRADED AREAS SHALL BE CUT WITHOUT THE PERMISSION OF THE ENGINEER.
- CONTRACTOR SHALL SAW CUT EXISTING PAVEMENT (EXISTING SURFACE AND BASE ASPHALT MATERIAL) ADJACENT TO PROPOSED CONSTRUCTION ITEMS.
- CONTRACTOR SHALL PROVIDE NO. 25 OR 26 CRUSHER RUN AGGREGATE FOR TEMPORARY RESIDENTIAL PARKING AS DIRECTED BY THE CITY OF MARTINSVILLE. COST OF MATERIAL AND THIS WORK SHALL BE INCLUDED IN COST BID FOR OTHER ITEMS.
- CDBG PROJECT SIGN IS NOT REQUIRED FOR THIS PROJECT.

**COORDINATES: ALLEY EXTENSION B**

PI STA. 10+00.00	N11079900.64	E3417825.55
PI STA. 11+14.77	N11079864.04	E3417717.02
PI STA. 11+73.23	N11079932.01	E3417698.03
PI STA. 12+23.10	N11079982.16	E3417704.53
PI STA. 12+80.22	N11080036.39	E3417683.60
PI STA. 13+58.22	N11080099.40	E3417637.63
PI STA. 13+80.00	N11080119.85	E3417614.04

**COORDINATES: ENTRANCE A B**

PI STA. 10+00.00	N11079941.66	E3417491.81
POT STA. 10+74.99	N11079886.94	E3417440.52
PI STA. 11+03.50	N11079866.15	E3417421.02
PI STA. 11+33.00	N11079889.39	E3417390.91

**COORDINATES: ENTRANCE B B**

PC STA. 29+85.86	N11079886.94	E3417440.52
PI STA. 30+08.37	N11079870.53	E3417425.12
PI STA. 30+51.00	N11079832.26	E3417458.20
PI STA. 31+05.00	N11079798.12	E3417500.13

**BENCH MARK:** PK NAIL IN POWER POLE AT INTERSECTION OF DILLARD STREET AND PROPOSED ALLEY ENTRANCE STA. 10+00 POLE NO. MED#15 ELEV. 813.21

**EROSION AND SILTATION CONTROL**

THE TEMPORARY EROSION AND SILTATION CONTROL ITEMS SHOWN ON THE E&S CONTROL PLAN ARE INTENDED TO PROVIDE A GENERAL PLAN FOR CONTROLLING EROSION AND SILTATION WITHIN THE PROJECT LIMITS. THE E&S CONTROL PLAN IS BASED ON FIELD CONDITIONS AT THE TIME OF PLAN DEVELOPMENT AND AN ASSUMED SEQUENCE OF CONSTRUCTION. THE CONTRACTOR, IN CONJUNCTION WITH THE PROJECT ENGINEER AND/OR ENVIRONMENTAL MONITOR, SHALL ADJUST THE LOCATION, QUANTITY AND TYPE OF EROSION AND SILTATION CONTROL ITEMS REQUIRED BASED ON THE ACTUAL FIELD CONDITIONS ENCOUNTERED AT THE TIME OF CONSTRUCTION AND THE SELECTED SEQUENCE OF CONSTRUCTION.

THE AREAS BEYOND THE PROJECT'S CONSTRUCTION AREA ARE TO BE PROTECTED FROM SILTATION. PERIMETER CONTROLS SUCH AS FILTER BARRIER, SILT FENCE, DIVERSION DIKES, TURBIDITY CURTAINS, ETC. SHALL BE INSTALLED PRIOR TO ANY GRUBBING OPERATIONS OR OTHER EARTH MOVING ACTIVITIES.

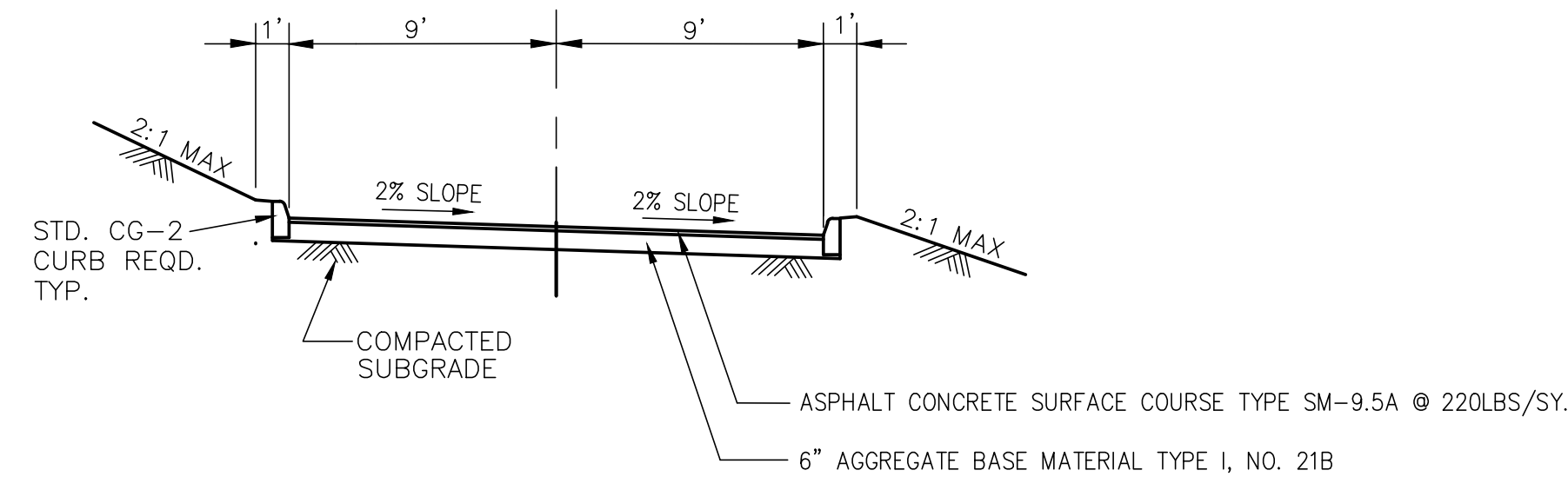

**TYPICAL SECTION ALLEY EXTENSION**  
(OFF OF DILLARD STREET)  
NO SCALE

STA 10+00.00 TO 10+88.43. DO NOT CROWN PVMT., 2% CROSS SLOPE FROM EP TO EP DOWN TO THE WEST SIDE OF ALLEY.

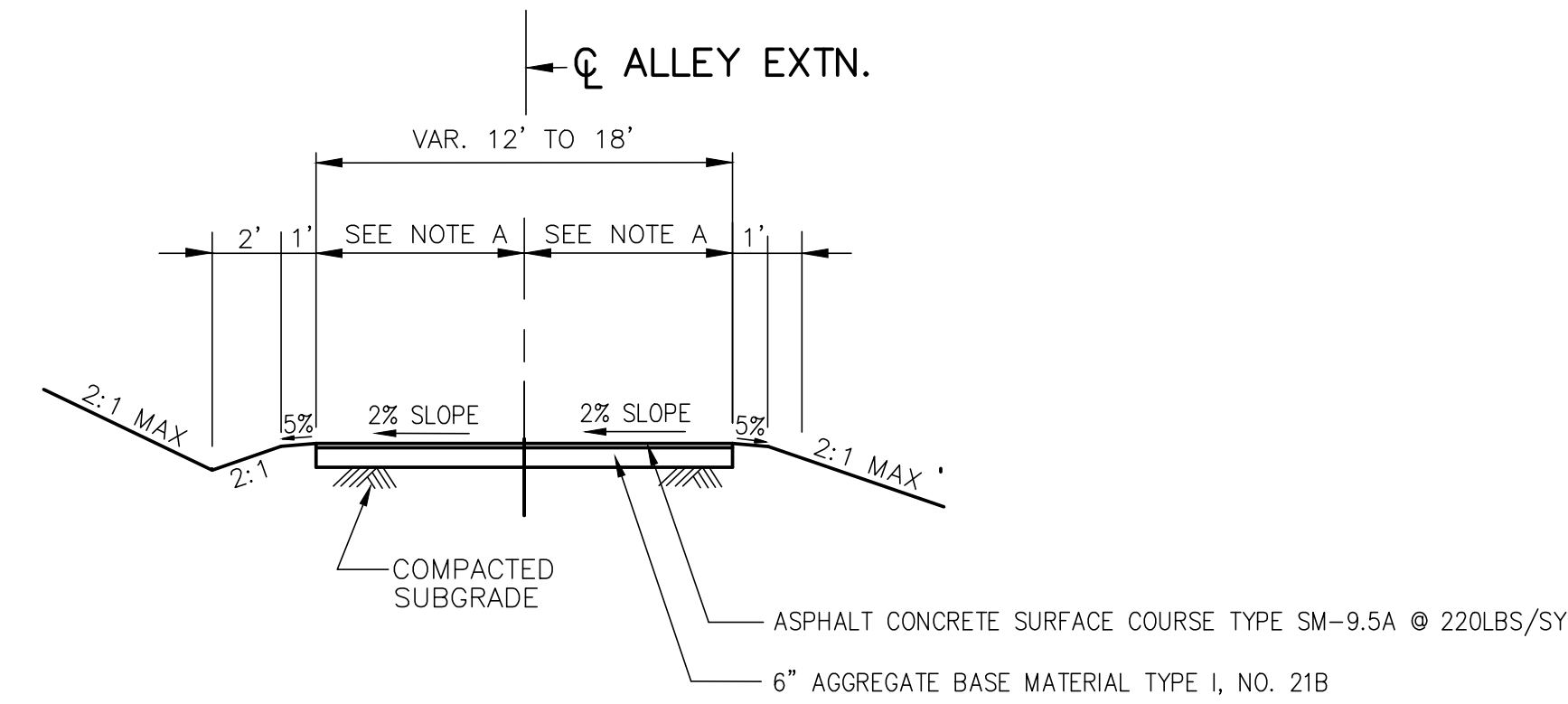

**TYPICAL SECTION ALLEY EXTENSION**  
(OFF OF DILLARD STREET)  
NO SCALE

NOTE A:  
VARIABLE WIDTH (9' TO 6' TRANSITION) FROM STA 10+88.43 TO 11+29.00  
6' WIDE FROM STA 11+29.00 TO 11+98.97. DO NOT CROWN PVMT., 2% CROSS SLOPE FROM EP TO EP DOWN TO THE NORTH SIDE OF THE ALLEY.  
STA. 11+98.97 TO 13+80.00-CROWN PVMT. AT @ MAINTAIN EXISTING ALLEY WIDTH AND GRADE. NO SHOULDER OR DITCH IMPROVEMENT REQUIRED.

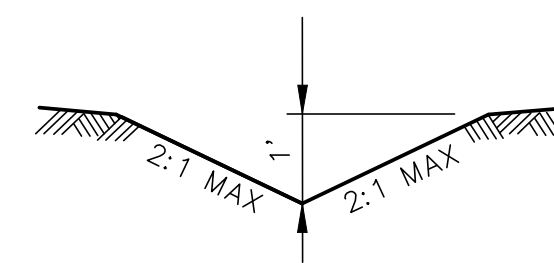

**DITCH DETAIL A**  
NO SCALE

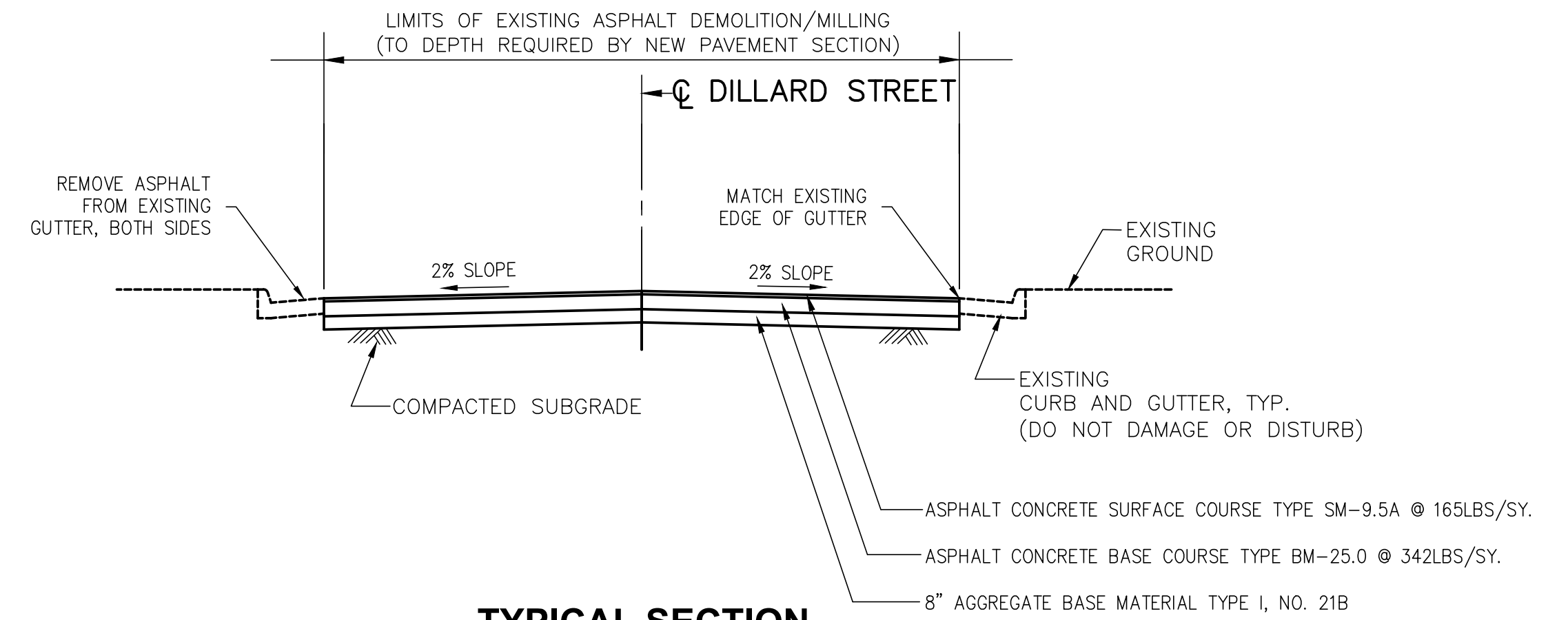

**TYPICAL SECTION DILLARD STREET**  
NO SCALE

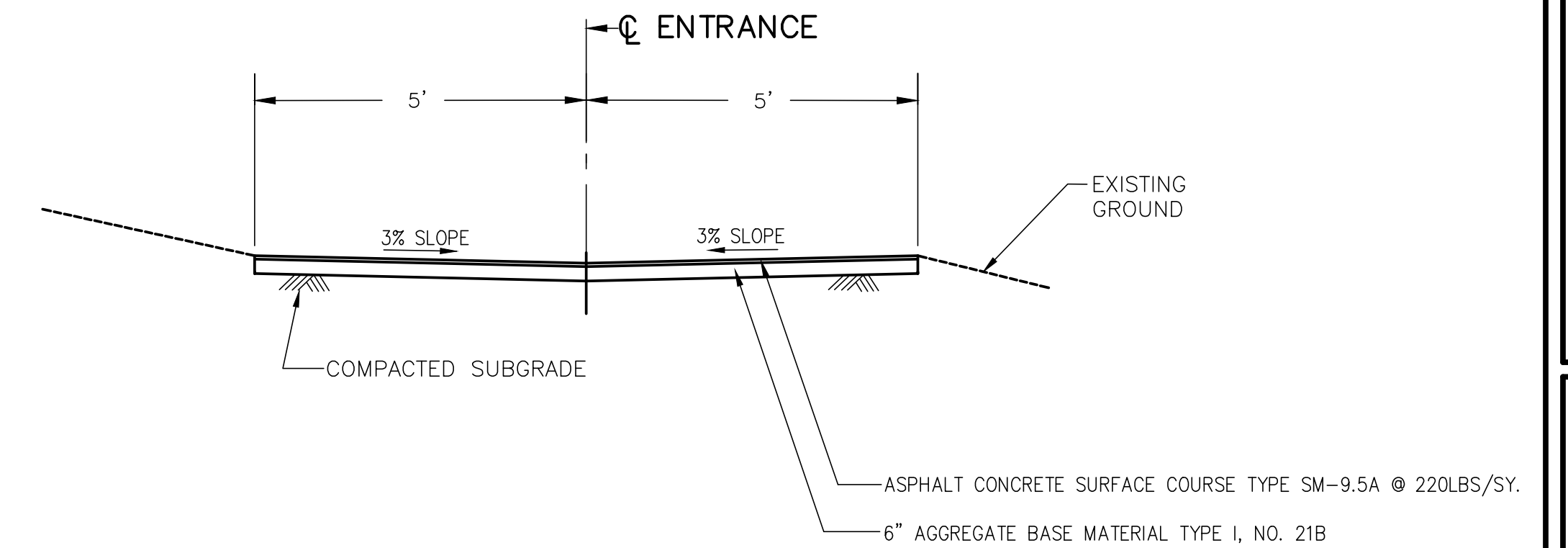

**TYPICAL SECTION ENTRANCE**  
(OFF OF WARREN COURT CUL-DE-SAC)  
NO SCALE

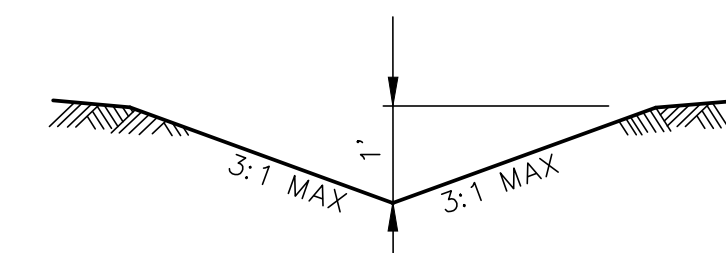

**DITCH DETAIL B**  
NO SCALE



Date:	
Revisions:	

Issue Date:	August 14, 2016
Drawn By:	WCB
Designed By:	FBM
Checked By:	MSA
Date:	8/10/16

**Mattern & Craig**  
ENGINEERS SURVEYORS  
701 FIRST STREET, S.W.  
ROANOKE, VIRGINIA 24016  
(540) 345-9342  
FAX (540) 345-7891

NORTHSIDE NEIGHBORHOOD IMPROVEMENT PLAN  
DILLARD STREET AND ALLEY IMPROVEMENTS  
**TYPICAL SECTIONS AND NOTES -**  
EXISTING ALLEY EXTENSION (OFF OF DILLARD ST)  
AND ENTRANCE OFF OF WARREN COURT  
MARTINSVILLE, VIRGINIA

Vertical Scale:  
NO SCALE

Horizontal Scale:  
NO SCALE

Commission Number:  
3514

Sheet No.:  
**2**



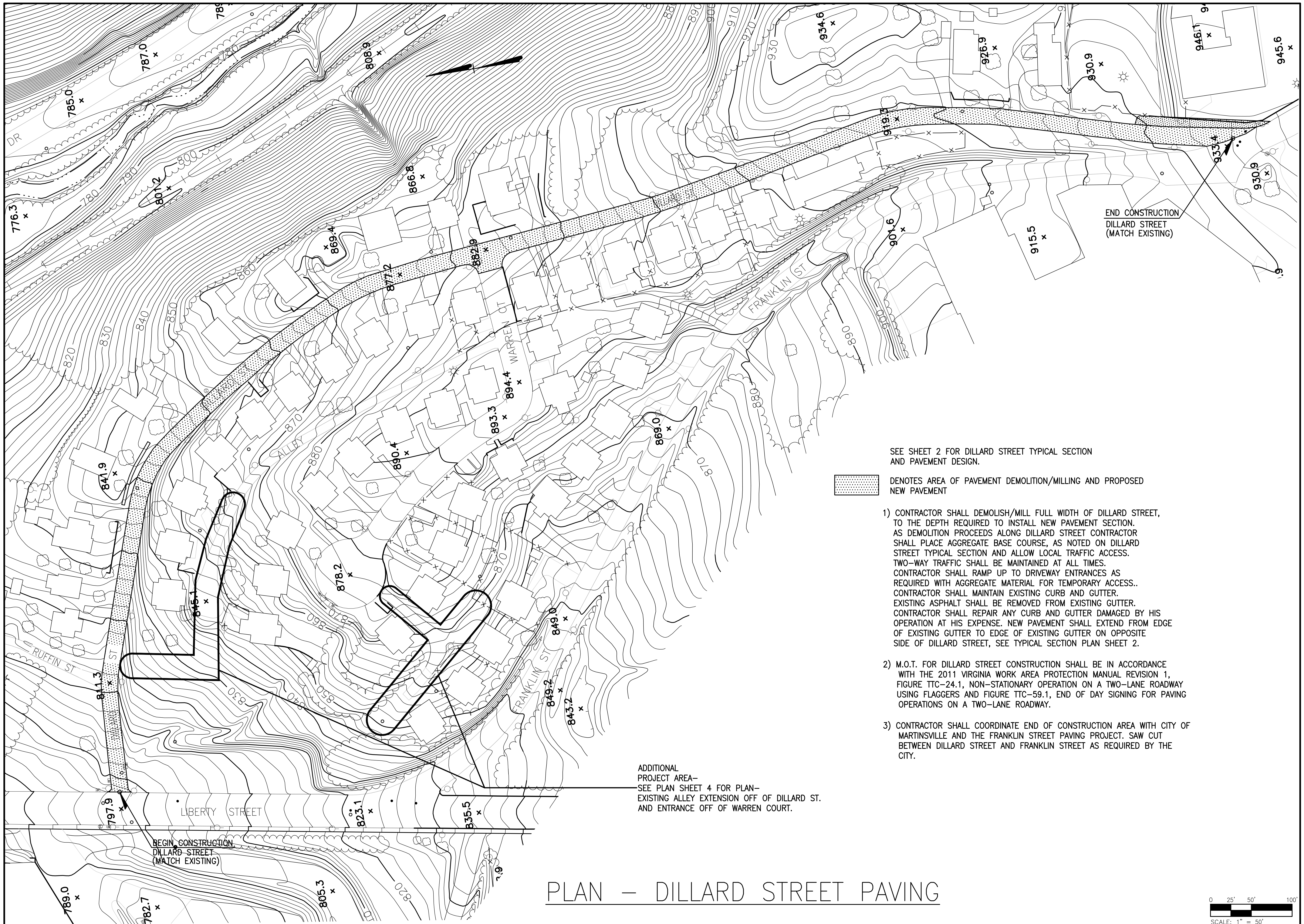

SEE SHEET 2 FOR DILLARD STREET TYPICAL SECTION AND PAVEMENT DESIGN.

 DENOTES AREA OF PAVEMENT DEMOLITION/MILLING AND PROPOSED NEW PAVEMENT

- 1) CONTRACTOR SHALL DEMOLISH/MILL FULL WIDTH OF DILLARD STREET, TO THE DEPTH REQUIRED TO INSTALL NEW PAVEMENT SECTION. AS DEMOLITION PROCEEDS ALONG DILLARD STREET CONTRACTOR SHALL PLACE AGGREGATE BASE COURSE, AS NOTED ON DILLARD STREET TYPICAL SECTION AND ALLOW LOCAL TRAFFIC ACCESS. TWO-WAY TRAFFIC SHALL BE MAINTAINED AT ALL TIMES. CONTRACTOR SHALL RAMP UP TO DRIVEWAY ENTRANCES AS REQUIRED WITH AGGREGATE MATERIAL FOR TEMPORARY ACCESS.. CONTRACTOR SHALL MAINTAIN EXISTING CURB AND GUTTER. EXISTING ASPHALT SHALL BE REMOVED FROM EXISTING GUTTER. CONTRACTOR SHALL REPAIR ANY CURB AND GUTTER DAMAGED BY HIS OPERATION AT HIS EXPENSE. NEW PAVEMENT SHALL EXTEND FROM EDGE OF EXISTING GUTTER TO EDGE OF EXISTING GUTTER ON OPPOSITE SIDE OF DILLARD STREET, SEE TYPICAL SECTION PLAN SHEET 2.
- 2) M.O.T. FOR DILLARD STREET CONSTRUCTION SHALL BE IN ACCORDANCE WITH THE 2011 VIRGINIA WORK AREA PROTECTION MANUAL REVISION 1, FIGURE TTC-24.1, NON-STATIONARY OPERATION ON A TWO-LANE ROADWAY USING FLAGGERS AND FIGURE TTC-59.1, END OF DAY SIGNING FOR PAVING OPERATIONS ON A TWO-LANE ROADWAY.
- 3) CONTRACTOR SHALL COORDINATE END OF CONSTRUCTION AREA WITH CITY OF MARTINSVILLE AND THE FRANKLIN STREET PAVING PROJECT. SAW CUT BETWEEN DILLARD STREET AND FRANKLIN STREET AS REQUIRED BY THE CITY.

ADDITIONAL PROJECT AREA— SEE PLAN SHEET 4 FOR PLAN— EXISTING ALLEY EXTENSION OFF OF DILLARD ST. AND ENTRANCE OFF OF WARREN COURT.

# PLAN — DILLARD STREET PAVING

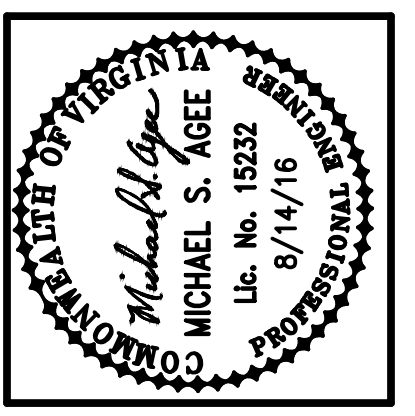
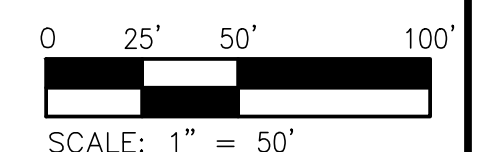

Revisions	Date

Issue Date: August 14, 2016  
 Drawn By: WCB  
 Designed By: FSM  
 Checked By: MSA  
 Date: 8/10/16

**Mattern & Craig**  
 ENGINEERS SURVEYORS  
 701 FIRST STREET, S.W.  
 ROANOKE, VIRGINIA 24016  
 (540) 345-9342  
 FAX (540) 345-7891

NORTHSIDE NEIGHBORHOOD IMPROVEMENT PLAN  
 DILLARD STREET AND ALLEY IMPROVEMENTS  
**PLAN — DILLARD STREET PAVING**  
 MARTINSVILLE, VIRGINIA

Vertical Scale: 1" = 50'
Horizontal Scale: 1" = 50'
Commission Number: 3514
Sheet No.: <b>3</b>



**CURVE DATA**

**CURVE ①**  
 $\Delta = 13.00'$   
 $R = 25.00'$   
 $D = 229.18'$   
 $L = 40.58'$   
 $T = 26.34'$

**CURVE ②**  
 $\Delta = 23.00'$   
 $R = 130.00'$   
 $D = 44.07369'$   
 $L = 52.19'$   
 $T = 26.45'$

**CURVE ③**  
 $\Delta = 28.50'$   
 $R = 95.00'$   
 $D = 60.31137'$   
 $L = 47.25'$   
 $T = 24.13'$

**CURVE DATA**

**CURVE ④**  
 $\Delta = 84.50'$  LT.  
 $R = 25.00'$   
 $D = 229.18'$   
 $L = 36.87'$   
 $T = 22.71'$   
 $PC = 10+80.79$   
 $PI = 11+03.50$   
 $PT = 11+17.66$

**CURVE ⑤**  
 $\Delta = 84.00'$  RT.  
 $R = 25.00'$   
 $D = 229.18'$   
 $L = 36.65'$   
 $T = 22.51'$   
 $PC = 29+85.86$   
 $PI = 30+08.37$   
 $PT = 30+22.51$

**EROSION AND SEDIMENT CONTROL LEGEND**

- ▼ (RCD) DENOTES ROCK CHECK DAM, TYPE II, STD EC-4
- ▲ (DD) DENOTES TEMPORARY DIVERSION DIKE, STD. EC-9
- ⊗ (TSB) DENOTES TEMPORARY SILT BARRIER, STD. EC-5
- (IP) DENOTES TEMPORARY INLET PROTECTION, TYPE C, STD. EC-6
- ⊙ (CE) DENOTES TEMPORARY CONSTRUCTION ENTRANCE, STD. EC-11
- ⊖ (SD) DENOTES TEMPORARY BERM AND SLOPE DRAIN, STD. EC-10
- (Dotted) DENOTES PROPOSED NEW PAVEMENT.

BEGIN CONST.  
 ALLEY EXTEN.  
 STA 10+00  
 (FACE OF  
 EXIST. CURB)  
 MATCH EXIST.

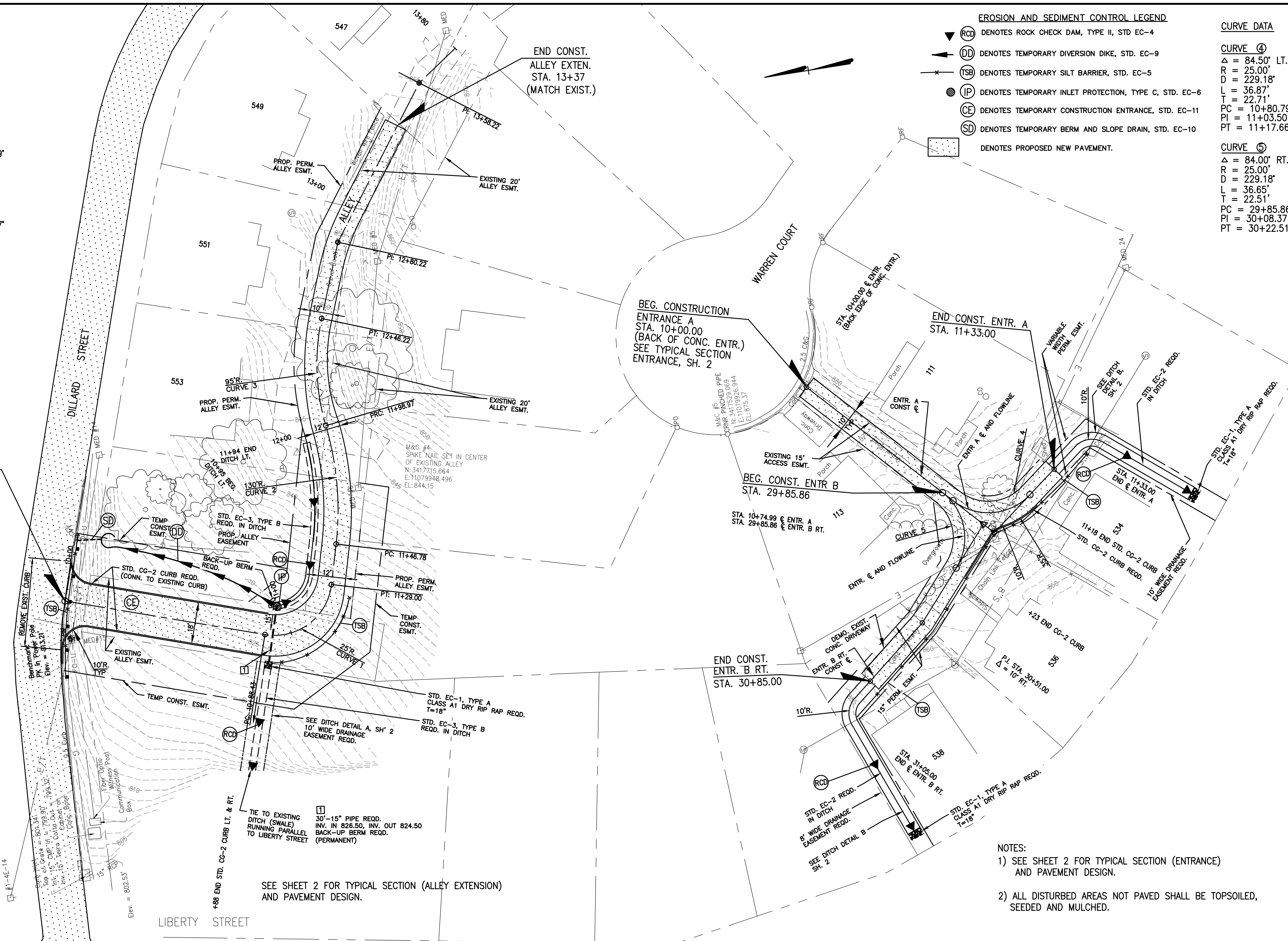

SEE SHEET 2 FOR TYPICAL SECTION (ALLEY EXTENSION)  
 AND PAVEMENT DESIGN.

- NOTES:**
- 1) SEE SHEET 2 FOR TYPICAL SECTION (ENTRANCE) AND PAVEMENT DESIGN.
  - 2) ALL DISTURBED AREAS NOT PAVED SHALL BE TOPSOILED, SEEDED AND MULCHED.

**PLAN - EXISTING ALLEY EXTENSION  
 OFF OF DILLARD STREET**

**PLAN - ENTRANCE OFF WARREN COURT**

M&C #3  
 IRON PIN W/CAP SET IN  
 WESTERN R/W OF LIBERTY ST  
 N: 3417736.755  
 E: 11079683.640  
 EL: 807.21

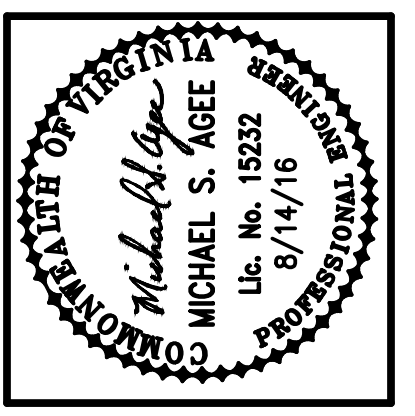
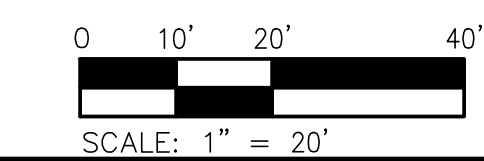

Issue Date:	August 14, 2016
Drawn By:	WCB
Designed By:	EBM
Checked By:	MSA
Date:	8/10/2016

**Mattern & Craig**  
 ENGINEERS SURVEYORS  
 701 FIRST STREET, S.W.  
 ROANOKE, VIRGINIA 24016  
 (540) 345-9342  
 FAX (540) 345-7891

**NORTHSIDE NEIGHBORHOOD IMPROVEMENT PLAN**  
 DILLARD STREET AND ALLEY IMPROVEMENTS  
**PLAN - EXISTING ALLEY EXTENSION (OFF OF DILLARD ST)  
 AND ENTRANCE OFF OF WARREN COURT**  
 MARTINSVILLE, VIRGINIA

Vertical Scale:	N/A
Horizontal Scale:	1" = 20'
Commission Number:	3514
Sheet No.:	<b>4</b>





# ROADSIDE DEVELOPMENT

## CORE MIX

MIX	LBS./ACRES	DESCRIPTION
1	▲ 200	* 100% CERTIFIED FINE FESCUE
2	▲ 100	100% CERTIFIED TALL FESCUE
3	▲	50% CERTIFIED TALL FESCUE * 50% CERTIFIED FINE FESCUE
4	▲	50% ORCHARDGRASS 50% CERTIFIED KENTUCKY BLUEGRASS
5		100% BERMUDAGRASS
TEMPORARY		
3/1 - 5/16 AND	50	50% CERTIFIED TALL FESCUE
8/16 - 3/1	50	50% BARLEY, WINTER RYE OR WINTER WHEAT
5/16 - 8/16	50	50% FOXTAIL MILLET
	50	50% CERTIFIED TALL FESCUE

## ADDITIVES

MIX	LBS./ACRES	DESCRIPTION
A	▲	100% LOVEGRASS
B	▲ 20	100% BARLEY, WINTER RYE OR WINTER WHEAT
C	▲	100% FOXTAIL MILLET
D	▲ 10	100% ANNUAL RYEGRASS
E	▲ 20	100% CROWN VETCH (LEGUME)
F	▲	100% SERICEA LESPEDEZA (LEGUME)
G	▲	100% BIRDSFOOT TREFOIL (LEGUME)
H	▲ 10	100% BLUE GRAMA
I	▲	
J	▲	
K	▲	

- ▲ ALL RATES TO BE SPECIFIED BY THE ENGINEER.
- \* FINE FESCUES INCLUDE CHEWINGS, CREEPING RED, HARD, SHEEP

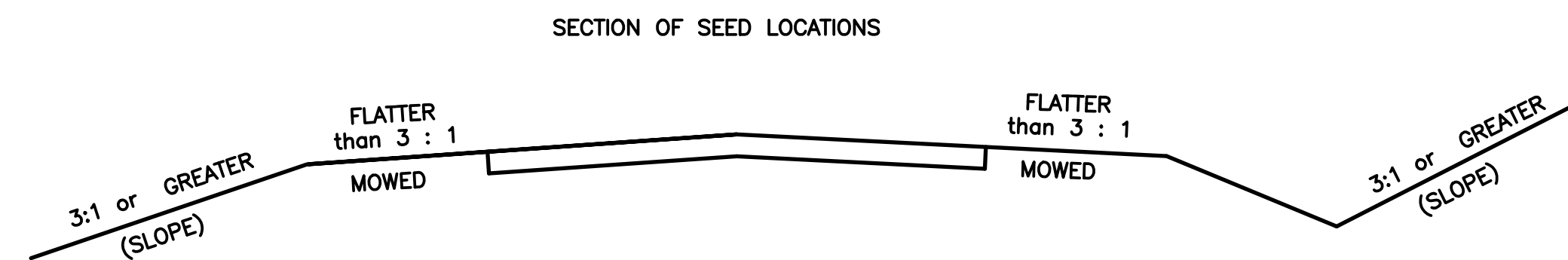

## NOTES:

APPROXIMATELY 0.20 ACRES WILL BE DISTURBED ON THIS PROJECT AND WILL REQUIRE THE ESTABLISHMENT OF GRASSES AND/OR LEGUMES.

NOTES FOR FIELD USE ONLY

OVERSEEDING RATES SHALL BE 100 PERCENT OF THE SEED MIXTURE SUPPLIED WITHOUT FERTILIZER.

THE ENGINEER WILL REQUIRE THE CONTRACTOR TO PERFORM SUPPLEMENTAL SEEDING WHEN LESS THAN 75 PERCENT UNIFORM STAND OF THE PERMANENT GRASS SPECIFIED IN THE MIXTURES IS OBTAINED. (ANNUAL SPECIES SUCH AS, RYE AND MILLET ARE TEMPORARY VARIETIES AND REQUIRE SUPPLEMENTAL SEEDING.)

NOTES APPLY TO SCHEDULE

LEGUME SEED MIXES (BIRDSFOOT TREFOIL, CROWN VETCH, AND SERICEA LESPEDEZA) AND WEEPING LOVEGRASS SHALL NOT BE USED ON SHOULDERS AND OTHER LOCATIONS FLATTER THAN 3:1 SLOPE.

LEGUME SEED SHALL BE INOCULATED WITH THE APPROPRIATE STRAIN AND RATE OF BACTERIA FOR HYDROSEEDING, USE FIVE TIMES THE DRY SEEDING RATE OF INOCULATE.

A TEMPORARY MIX OR EROSION CONTROL MULCH AS DIRECTED BY THE ENGINEER, IS TO BE USED ON AREAS THAT ARE TO BE REGRADED OR LATER DISTURBED, IF LEFT DORMANT FOR MORE THAN 15 DAYS.

EROSION CONTROL MULCH, AS DIRECTED BY THE ENGINEER, IS TO BE USED ON AREAS THAT ARE TO BE LEFT DORMANT FOR MORE THAN 15 DAYS BETWEEN DECEMBER 1 AND FEBRUARY 28.

EROSION CONTROL MULCH AS LISTED ON THE VDOT APPROVED PRODUCTS LIST, SHALL BE APPLIED IN ACCORDANCE WITH THE MANUFACTURER'S RECOMMENDATIONS.

EROSION CONTROL MULCH SHALL PROVIDE 100 PERCENT COVERAGE OF ALL DENUDED AREAS.

SPRING & SUMMER AND FALL & WINTER DEFINED FOR THE PURPOSE OF DETERMINING WHETHER HULLED OR UNHULLED BERMUDAGRASS AND SERICEA LESPEDEZA SEED IS REQUIRED:

SPRING & SUMMER 4/1 - 9/15 - USE HULLED SEED  
FALL & WINTER 9/15 - 4/1 - USE UNHULLED SEED

TYPE I MULCH (STRAW) TO BE USED ON NEWLY SEEDED AREAS ADJACENT TO ALL WATERWAYS, WETLANDS, SWAMPS, OR ANY AREA IN WHICH DRAINAGE FLOWS TOWARD AREAS UNDER THE JURISDICTION OF THE ENVIRONMENTAL REGULATORY AGENCIES.

TYPE I MULCH SHALL BE APPLIED TO PROVIDE A MINIMUM 90 PERCENT COVERAGE.

TYPE I MULCH SHALL BE TACKED WITH FIBER MULCH AT THE RATE OF 750 LBS. PER ACRE AND/OR MULCH TACKIFIER.

TYPE II MULCH (FIBER MULCH) MAY BE SUBSTITUTED FOR TYPE I MULCH AT THE RECOMMENDATION OF THE ENGINEER.

TYPE II MULCH SHALL BE APPLIED AT A RATE OF 1500 LBS. (NET DRY WEIGHT) PER ACRE TO PROVIDE A MINIMUM OF 90 PERCENT COVERAGE, AND SHALL BE APPLIED IN A SEPARATE APPLICATION.

ALL TOPSOIL IS TO BE FREE OF HARD LUMPS, CLODS, ROCKS AND FOREIGN DEBRIS AND IS TO BE HAND RAKED TO TIE INTO EXISTING LAWNS.

ALL SEED MUST BE IN CONFORMANCE WITH VDOT SEED SPECIFICATIONS FOR GRASSES & LEGUMES AND BE PROVIDED AT THE PROJECT SITE IN BAGS NOT OPENED AND LABELED FOR USE ON VDOT PROJECTS WITH A GREEN TAG CERTIFYING INSPECTION BY THE VIRGINIA CROP IMPROVEMENT ASSOCIATION.

## MIX REQUIREMENTS THIS PROJECT

RECOMMENDATIONS FOR THE APPLICATION OF SEED MIXTURES (CORE MIX AND ADDITIVES), FERTILIZER, LIME ETC. ARE TO BE OBTAINED FROM THE ENGINEER.

## ROADSIDE DEVELOPMENT SUMMARY

PROJECT NUMBERS	⊗ TOP SOIL 2" CLASS		REGULAR SEED	OVER SEEDING	LIME	FERT. 15-30-15	LEGUME SEED	LEGUME OVER SEED	TEMPORARY SEEDING
	A	B							
	ACRES	LBS.	LBS.	TONS	TONS	LBS.	LBS.	LBS.	
	0.20	63	39	1	0.10	5	3	20	

⊗ DENOTES ITEMS TO BE PAID FOR ON BASIS OF PLAN QUANTITIES IN ACCORDANCE WITH CURRENT ROAD AND BRIDGE SPECIFICATIONS.

## SEEDING SCHEDULE

PROJECT NUMBERS	SLOPES SEED MIX WITH ADDITIVE	MOWED SEED MIX WITH ADDITIVE	SLOPES SEED MIX WITH ADDITIVE	MOWED SEED MIX WITH ADDITIVE	SLOPES SEED MIX WITH ADDITIVE	MOWED SEED MIX WITH ADDITIVE
	SPRING MONTH & DATE		SUMMER MONTH & DATE		FALL & WINTER MONTH & DATE	
	4/1 - 6/1	6/1 - 9/15	9/15 - 4/1			
	2E	1D	2E	1H	2E	1B
* SPECIFY KIND OF FINE FESCUE	Hard	Hard	Hard	Hard	Hard	Hard

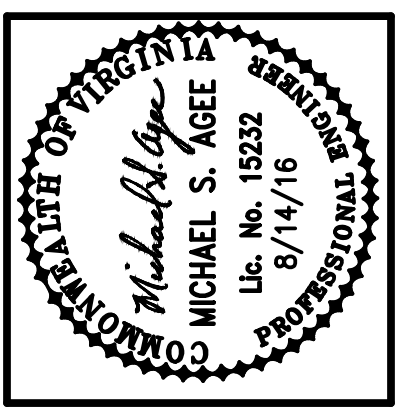

Date	Revisions

Issue Date:	Drawn By: WCB	Designed By: RBM	Checked By: MSA	Date: 8/10/16
-------------	---------------	------------------	-----------------	---------------

**Mattern & Craig**  
ENGINEERS SURVEYORS  
701 FIRST STREET, S.W.  
ROANOKE, VIRGINIA 24016  
(540) 345-9342  
FAX (540) 345-7891

NORTHSIDE NEIGHBORHOOD IMPROVEMENT PLAN  
DILLARD STREET AND ALLEY IMPROVEMENTS  
**ROADSIDE DEVELOPMENT**  
MARTINSVILLE, VIRGINIA

Vertical Scale:  
NO SCALE

Horizontal Scale:  
NO SCALE

Commission Number:  
3514

Sheet No.:  
**6**